



Technical Rider – Sala 2 Equipment List

Audio:

EAW Line Array 8 x JFL210
EAW 4 Subs SB1000ZR
Midas M32 mixer
Midas DL32 stage
6 Monitors HK LP115 400Watts
Side Fill - 2 Sub 18 RCF + HK Linear 12

Lighting (more details on request):

2 2xMolfay 200W Blinder WW /CW
4 Beams 7R 230W
10 Wash Zoom 19x15W
4 Moving Heads Spot 90W Led
8 Led Beam 90W RGBW DOT (across the room)
2 PC LED 200W RGB
Smoke 1500W
MA ON PC – Command Wing

Risers:

6 units 2m x 1m
Heights: 1, 0.8, 0.6, 0.4, 0.3, 0.2 m

Microphones/DIs:

4 Shure SM58
4 Shure SM57
1 Shure Beta 52
1 Shure Beta 91A
4 Sennheiser E604
2 Sennheiser E914
2 AKG Ck91
1 AKG P170
2 Wireless SHURE SM58
2 Active DI Box BSS133
4 Active DI Box ART Xdirect
2 Passive DI Box Palmer PAN 04 Stereo

Video Wall (Extra on request):

P6 Linsn Driver/Sender
4 x 3 mts.

Stage:

9,00m x 6,00m x 1,00 m

This list may change with no further notice due to failure or maintenance issues.

Floor Plans and Areas – Sala 2

Level 0

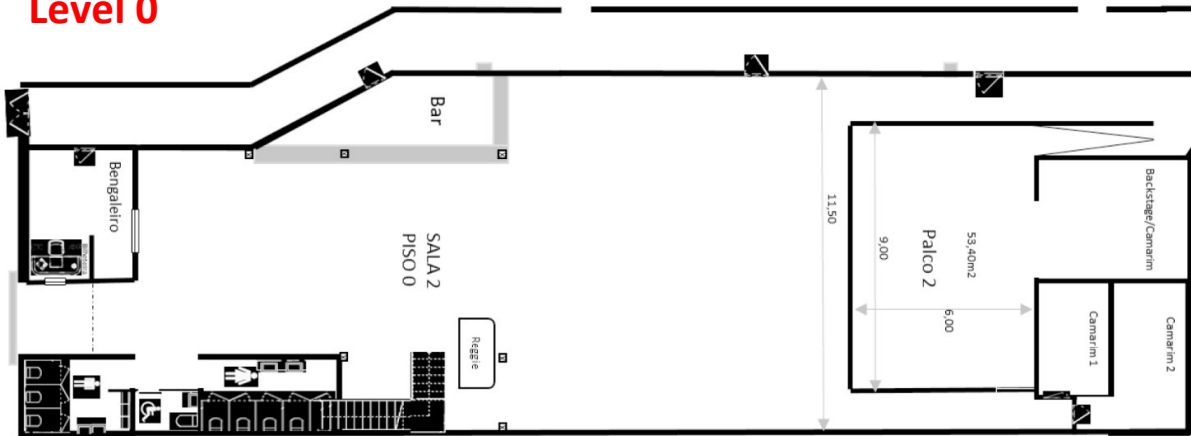

Level 1

